

## Ponzio SL1600TTHI

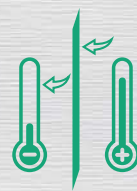
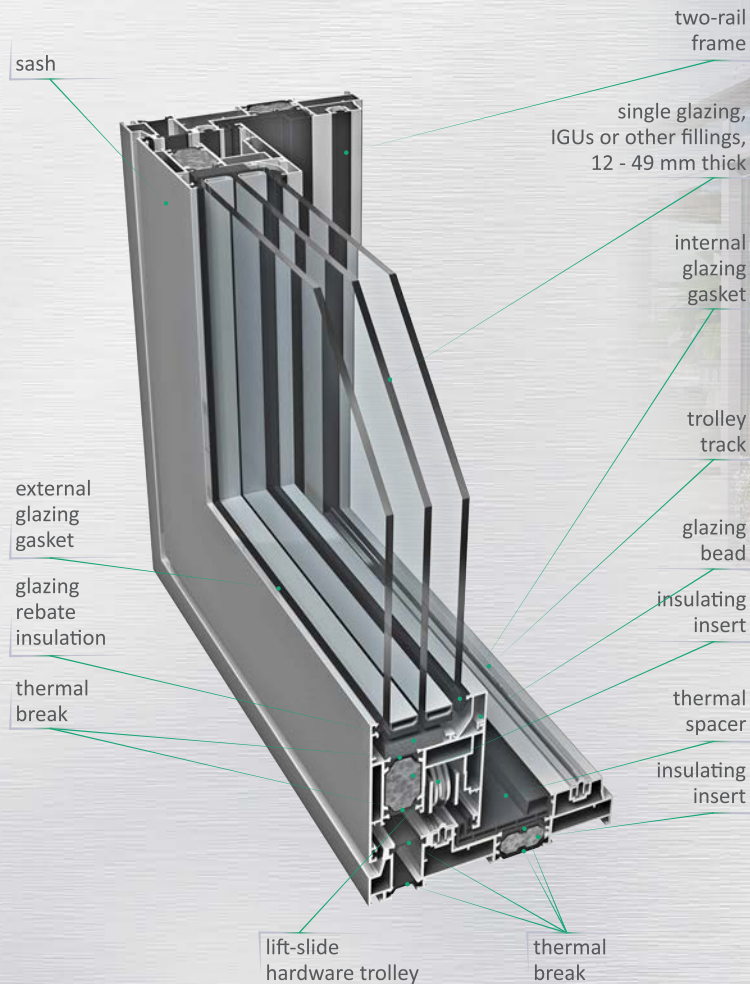

$$U_w = 1.0 \text{ W/m}^2\text{K}$$

\*reference construction dimensions:  
L 2400 x H 2400 mm,  $U_g = 0.5 \text{ W/m}^2\text{K}$ ,  
triple glazing

An insulated aluminium profile system designed for the construction of external lift-slide joinery.

- › large-dimension constructions with up to 8 sashes possible
- › high resistance to weather conditions
- › automatic drives available
- › corner floating mullion solution
- › low threshold available
- › different thermal insulation variants with different insulation inserts: SL1600TT, SL1600TT+, SL1600TTHI, SL1600TTSHI
- › PLUS version:  $U_f$  frame heat transfer coefficient as low as  $2.1 \text{ W/m}^2\text{K}$
- › HI versionL:  $U_f$  frame heat transfer coefficient as low as  $1.8 \text{ W/m}^2\text{K}$

## Ponizio SL1600TTHI

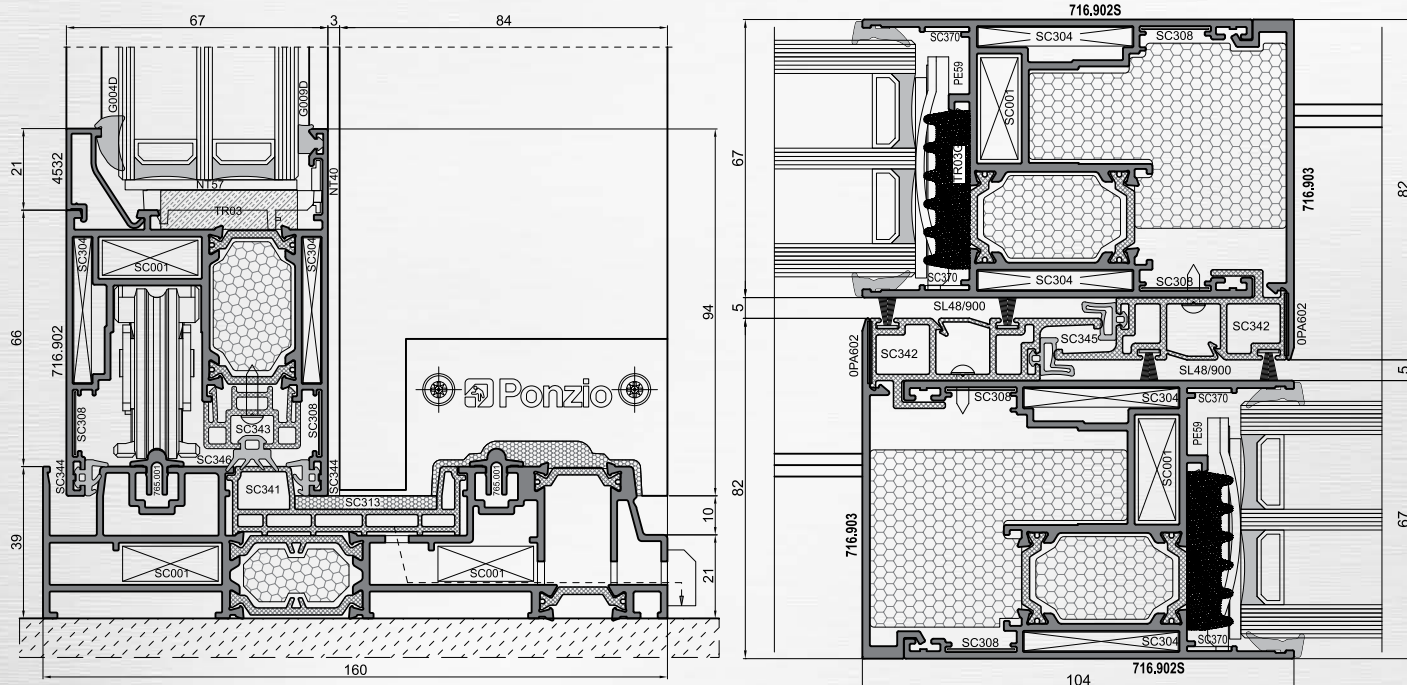

### Technical parameters

<b>Filling thickness</b>	»» 12-49 mm
<b>Sash depth</b>	»» 67 mm
<b>Frame depth</b>	»» 160/154 mm two-rail frame 247/241 mm three-rail frame
<b>Maximum sash dimensions</b>	»» L 3300 x H 3000 mm L 2300 x H 3500 mm
<b>Maximum sash weight</b>	»» 300/400 kg
<b>Air permeability</b>	»» class 4
<b>Watertightness</b>	»» class 9A
<b>Resistance to wind load</b>	»» class C3/B5
<b>Thermal insulation</b>	»» SL1600TT: $U_f$ from 2.3 W/m <sup>2</sup> K SL1600TTHI: $U_f$ from 1.8 W/m <sup>2</sup> K
<b>Thermal insulation</b>	»» SL1600TT: $U_w$ from 1.1 W/m <sup>2</sup> K SL1600TTHI: $U_w$ from 1.0 W/m <sup>2</sup> K
<b>Certification</b>	»» type testing in acc. with EN 14351-1 + A1
<b>Resistance to burglary</b>	»» class RC2 in acc. with EN 1627

## PONZIO SL1600tt PONZIO SL1600tt SLIM

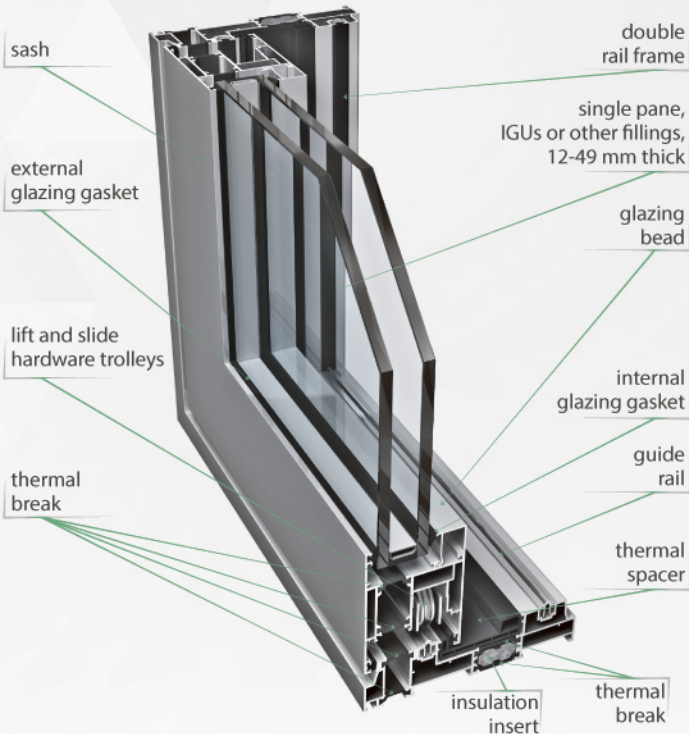

$$U_w = 1.1 \text{ W/m}^2\text{K}$$

\*calculated for W 2400 x H 2400 mm window,  
 $U_g = 0.5 \text{ W/m}^2\text{K}$ , triple glazed unit

$$U_w = 1.5 \text{ W/m}^2\text{K}$$

$U_g = 1.0 \text{ W/m}^2\text{K}$ , double glazed unit

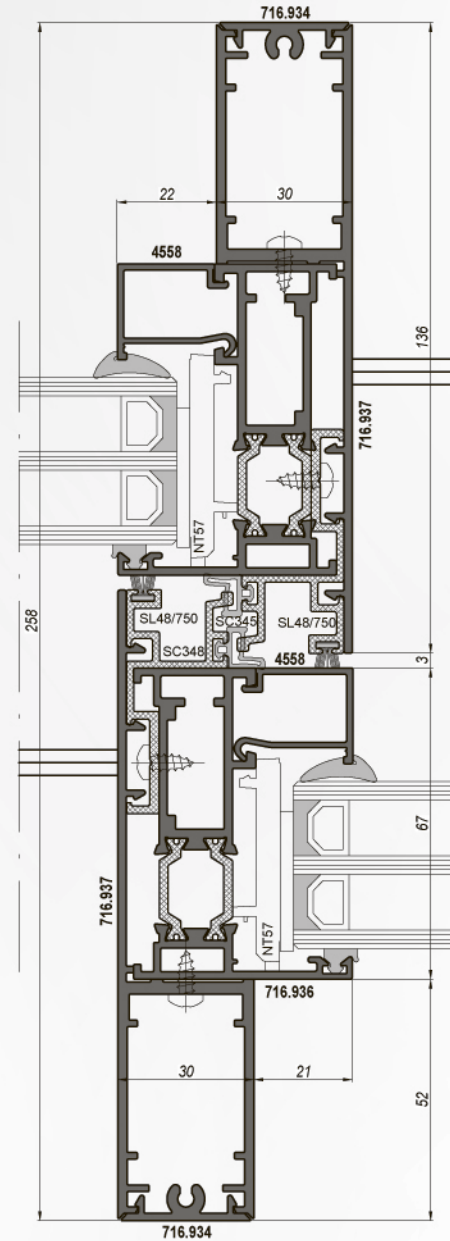

$$U_w = 1.1 \text{ W/m}^2\text{K}$$

\*calculated for window: W 2400 x H 2400 mm  
 $U_g = 0.5 \text{ W/m}^2\text{K}$ , triple glazed unit

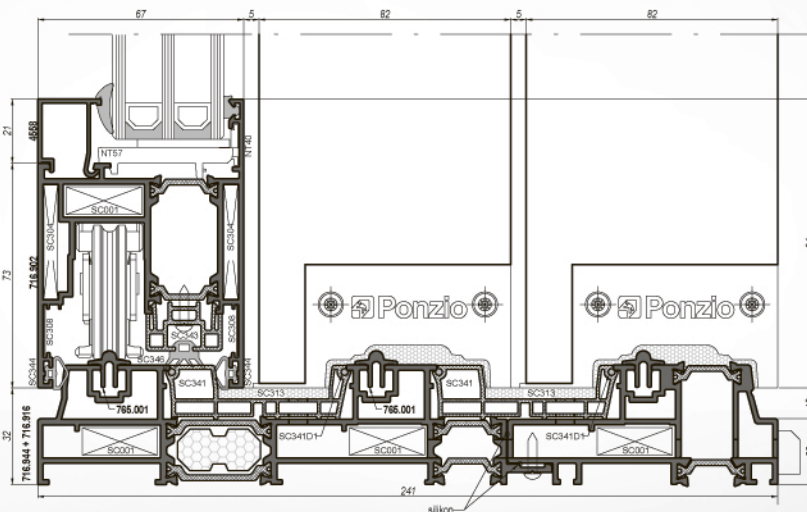

- aluminium system with thermal insulation designed for external sliding windows and doors
- constructions of large dimensions, up to 8 sashes available due to profile design
- profile depth: sliding sash - 37 mm, double rail frame - 160 mm, triple rail frame - 247 mm, quadruple rail frame - 334 mm
- glazing thickness range 12 - 49 mm
- high resistance to weather conditions
- SL1600tt, SL1600tt+ and SL1600tt HI system variants depending on used insulation inserts
- low threshold solution available
- corner connection with floating mullion
- trolley maximum lifting capacity 300 kg in standard, increased to 400 kg with additional trolleys
- automatic sliding drives available