

# SEMI-STRUCTURAL GLAZING CURTAIN WALL

## PONZIO PF152ESG

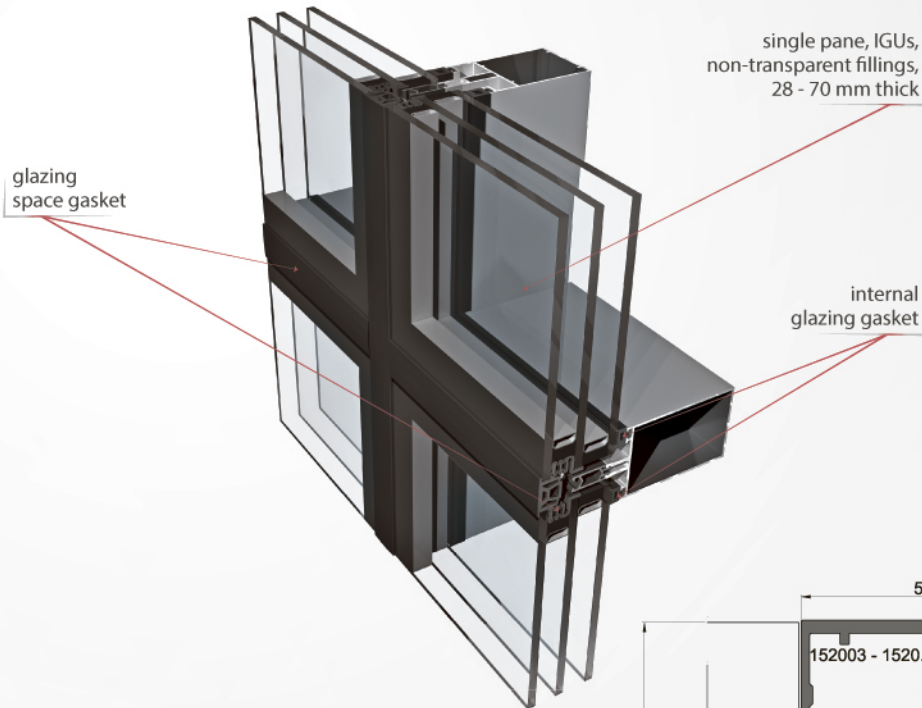

MODERN SOLUTION  
we can, we do



$$U_{cw} = 0.64 \text{ W/m}^2\text{K}$$

\*calculated for reference construction  
W 1200 x H 2500 mm i  $U_g = 0.5 \text{ W/m}^2\text{K}$   
triple glazed unit

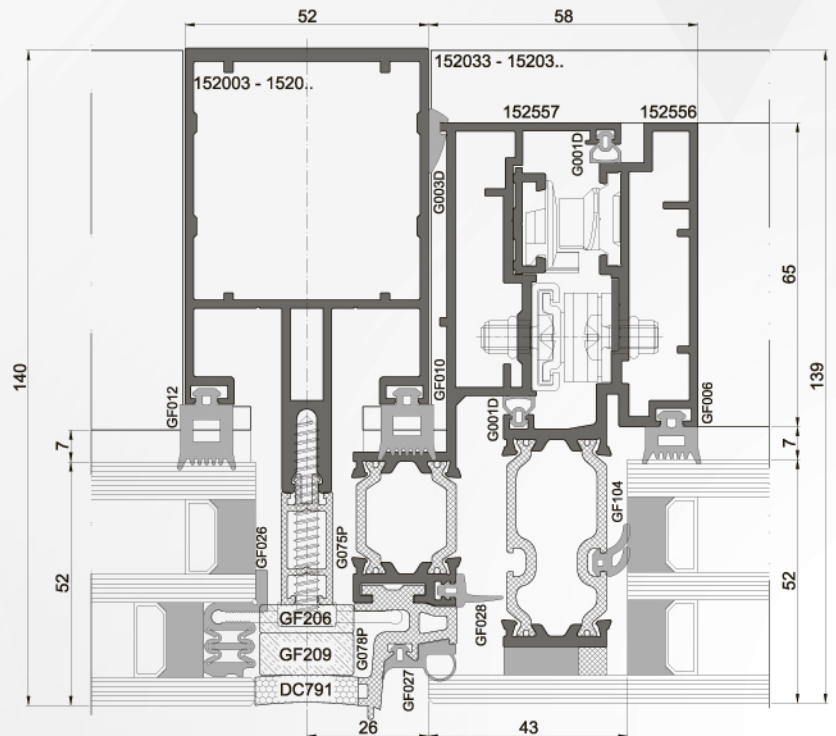

- structurally glazed curtain wall
- designed for curtain walls and spatial constructions
- based on the PF152 load bearing structure
- flush external glass surface with 22 mm (silicone joint) or 28 mm (system gasket) wide vertical and horizontal lines
- DGUs and TGUs available
- independently opening side-by-side top hung windows available
- triple glazed units up to 60 mm available
- arched constructions possible

# CURTAIN WALL WITH INTEGRATED WINDOW

## PONZIO PF152IW

**MS** MODERN SOLUTION  
we can, we do

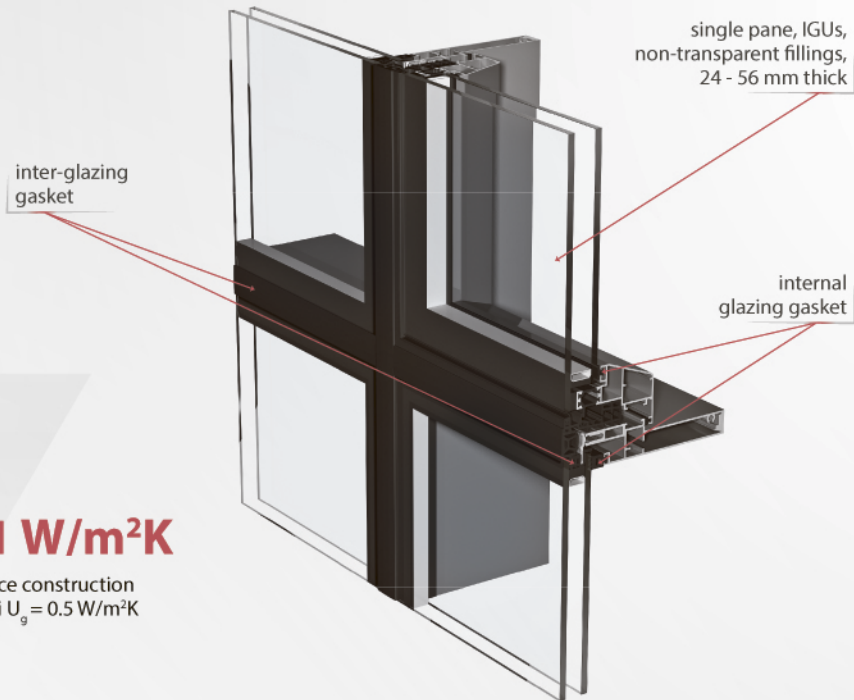

$$U_{cw} = 0.91 \text{ W/m}^2\text{K}$$

\*calculated for reference construction  
W 1200 x H 2500 mm i  $U_g = 0.5 \text{ W/m}^2\text{K}$   
triple glazed unit

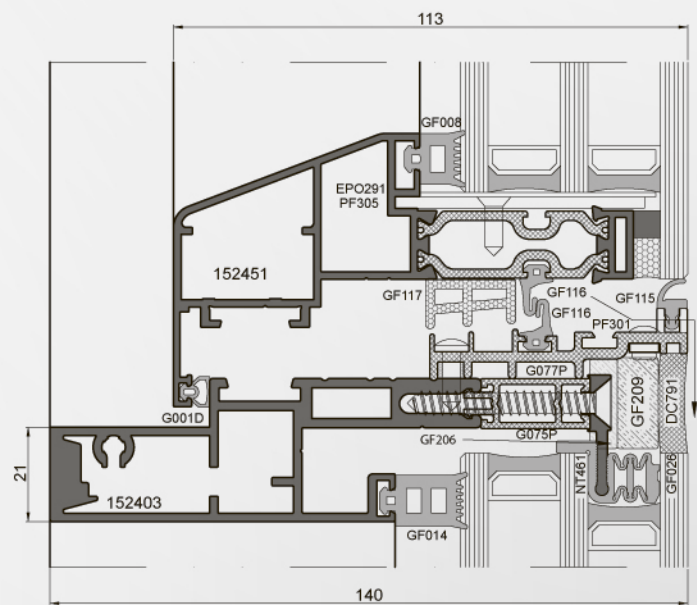
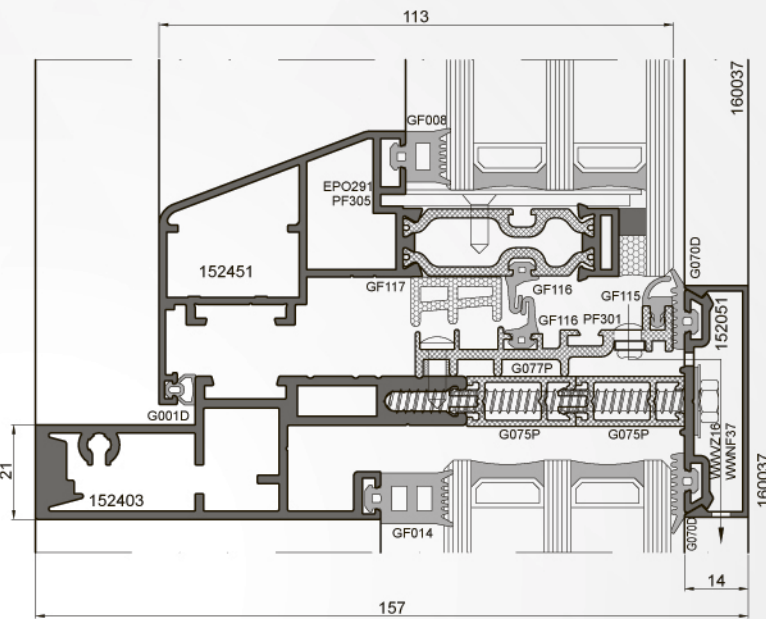

- aluminium mullion-transom curtain wall system with standard and semi-structural glazing
- variant of the PF152ESG semi-structurally glazed curtain wall with concealed inward opening windows
- flush external surfaces
- vertical and horizontal profile width: 21 mm
- structural profile depth: 76 mm, 100 mm, 124 mm
- window sash profile depth: 77 mm or 101 mm; glazing range: 24-56 mm